

GVK

G.V.KINSMAN PTY. LTD.

www.gvk.com.au

**INDUSTRIAL ELECTRICAL PRODUCT
COMPANY**

PRESSLOCK

THREADLESS METAL CONDUIT RANGE



660 SOMMERVILLE ROAD, WEST SUNSHINE, VIC 3020

PHONE:(03) 9312 6633

FAX:(03) 9312 6433

RELEASE : SEPT 2008

PRESSLOCK

THREADLESS METAL CONDUIT FITTINGS

SAVE TIME, MONEY & INCREASE PROFITS WITH PRESSLOCK'S CONDUIT FITTINGS

UNIQUE PRODUCT DESIGNED BY ELECTRICIANS FOR ELECTRICIANS

**CLIENTS WILL BE IMPRESSED BY A MECHANICALLY PROTECTED
QUALITY INSTALLATION USING PRESSLOCK CONDUIT FITTINGS**

TESTED AND APPROVED BY AUSTRALIAN STANDARDS AUTHORITY

CONFORMS TO AS/NZS 2053.7:2002 (APPROVAL NO# A/10278EA)

"CONDUITS AND FITTINGS FOR ELECTRICAL INSTALLATIONS & RIGID METAL CONDUIT FITTINGS"

**COMPATIBLE WITH SCREWED STEEL AND PVC CONDUIT USING SPECIALLY DESIGNED FITTINGS
PRESSLOCK PRODUCTS ARE RATED AT IP 65 AGAINST**

- EXTERNAL INFLUENCES
- INGRESS OF WATER
- INGRESS OF SOLID FOREIGN OBJECTS
- CORROSIVE AND POLLUTING SUBSTANCES
- SOLAR RADIATION
- RESISTANCE TO WATER

FOR USE IN MULTIPLE APPLICATIONS

- *ELECTRICAL INSTALLATION 240V/415V*
- *INTERNAL & EXTERNAL USE*
- *FIBER, SECURITY & DATA INSTALLATIONS*
- *INDUSTRIAL, COMMERCIAL, DOMESTIC*
- *HEAVY INDUSTRIAL*
- *PLANT ROOMS*
- *SCHOOLS*
- *HOSPITALS*
- *STAIRWELLS*
- *SILO'S*
- *ELEVATOR SHAFTS*

Refineries, Mining, Mills, Smelters, Port Authorities, Transport, Defence

NOTE: MANUFACTURER RECOMMENDS LOCTITE 510 OR EQUIVALENT GASKET FLANGE SEALANT BE USED IN CONJUNCTION WITH PRESSLOCK PRODUCTS TO ATTAIN THE IP65 RATING

PRESSLOCK

THREADLESS METAL CONDUIT FITTINGS



TESTED AND APPROVED BY
AUSTRALIAN STANDARDS
AUTHORITY AND
CONFORMING TO
AS/NZS 2053.7:2002
APPROVAL NO#
A/10278EA
CONDUITS AND FITTINGS
FOR ELECTRICAL
INSTALLATIONS AND RIGID
METAL CONDUIT FITTINGS

INGRESS IP RATING :

IP 65

RATED FOR USE IN
APPLICATIONS OF
240/415 VOLTS

TESTED FOR EARTH
CONTINUITY 0.01Ω

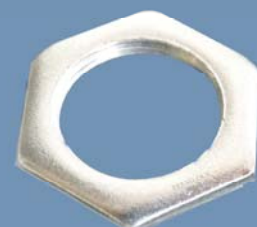

PRESSLOCK

THREADLESS METAL CONDUIT FITTINGS



METAL 1 WAY SHALLOW
JUNCTION BOX

PART NO#	SIZE	QTY
P20-M1WB	20MM	10
P25-M1WB	25MM	10



METAL 2 WAY SHALLOW
JUNCTION BOX

PART NO#	SIZE	QTY
P20-M2WB	20MM	10
P25-M2WB	25MM	10



METAL 3 WAY SHALLOW
JUNCTION BOX

PART NO#	SIZE	QTY
P20-M3WB	20MM	10
P25-M3WB	25MM	10



METAL 4 WAY SHALLOW
JUNCTION BOX

PART NO#	SIZE	QTY
P20-M4WB	20MM	10
P25-M4WB	25MM	10

PRESSLOCK

THREADLESS METAL CONDUIT FITTINGS



METAL INSPECTION TEE

PART NO#	SIZE	QTY
P20-MINTEE	20MM	10
P25-MINTEE	25MM	10



METAL INSPECTION ELBOW

PART NO#	SIZE	QTY
P20-MINELB	20MM	10
P25-MINELB	25MM	10



METAL PLAIN ELBOW

PART NO#	SIZE	QTY
P20-MELB	20MM	10
P25-MELB	N/A	N/A



METAL PLAIN BEND

PART NO#	SIZE	QTY
P20-MBEND	20MM	10
P25-MBEND	25MM	10

PRESSLOCK

THREADLESS METAL CONDUIT FITTINGS



METAL PLAIN JOINING COUPLING

PART NO#	SIZE	QTY
P20-MCOUP	20MM	20
P25-MCOUP	25MM	20



METAL FEMALE PLAIN TO SCREWED COUPLING

PART NO#	SIZE	QTY
P20-MFSCOUP	20MM	20
P25-MFSCOUP	25MM	10



METAL PLAIN TO SCREWED ADAPTOR

PART NO#	SIZE	QTY
P20-MSAD	20MM	20
P25-MSAD	25MM	10



METAL LOCK NUT

PART NO#	SIZE	QTY
P20-MLN	20MM	50
P25-MLN	25MM	50



METAL 25/20 CONDUIT REDUCER

PART NO#	SIZE	QTY
P25/20-MCR	25/20MM	20

PRESSLOCK

THREADLESS METAL CONDUIT FITTINGS

PART NUMBER	DESCRIPTION
P20-M1WB	METAL 20MM 1 WAY SHALLOW JUNCTION BOX - PAGE 4
P25-M1WB	METAL 25MM 1 WAY SHALLOW JUNCTION BOX - PAGE 4
P20-M2WB	METAL 20MM 2 WAY SHALLOW JUNCTION BOX - PAGE 4
P25-M2WB	METAL 25MM 2 WAY SHALLOW JUNCTION BOX - PAGE 4
P20-M3WB	METAL 20MM 3 WAY SHALLOW JUNCTION BOX - PAGE 4
P25-M3WB	METAL 25MM 3 WAY SHALLOW JUNCTION BOX - PAGE 4
P20-M4WB	METAL 20MM 4 WAY SHALLOW JUNCTION BOX - PAGE 4
P25-M4WB	METAL 25MM 4 WAY SHALLOW JUNCTION BOX - PAGE 4
P20-MINTEE	METAL 20MM INSPECTION TEE - PAGE 5
P25-MINTEE	METAL 25MM INSPECTION TEE - PAGE 5
P20-MINELB	METAL 20MM INSPECTION ELBOW - PAGE 5
P25-MINELB	METAL 25MM INSPECTION ELBOW - PAGE 5
P20-MBEND	METAL 20MM PLAIN BEND - PAGE 5
P25-MBEND	METAL 25MM PLAIN BEND - PAGE 5
P20-MELB	METAL 20MM PLAIN ELBOW - PAGE 5
P25-MELB	25MM NOT AVAILABLE
P20-MCOUP	METAL 20MM PLAIN JOINING COUPLING - PAGE 6
P25-MCOUP	METAL 25MM PLAIN JOINING COUPLING - PAGE 6
P20-MFSCOUP	METAL 20MM FEMALE PLAIN TO SCREWED COUPLING - PAGE 6
P25-MFSCOUP	METAL 25MM FEMALE PLAIN TO SCREWED COUPLING - PAGE 6
P20-MSAD	METAL 20MM PLAIN TO SCREWED ADAPTOR - PAGE 6
P25-MSAD	METAL 25MM PLAIN TO SCREWED ADAPTOR - PAGE 6
P20-MLN	METAL 20MM LOCKNUT - PAGE 6
P25-MLN	METAL 25MM LOCKNUT - PAGE 6
P25-MCR	METAL 25/20 CONDUIT REDUCER - PAGE 6
P20-SSS	METAL 20MM SINGLE SIDED SADDLE - PAGE 6
P25-SSS	METAL 25MM SINGLE SIDED SADDLE - PAGE 6



NOTE: MANUFACTURER RECOMENDS LOCTITE 510 OR EQUIVALENT GASKET FLANGE SEALANT BE USED IN CONJUNCTION WITH PRESSLOCK PRODUCTS TO ATTAIN THE IP65 RATING

GVK

G.V.KINSMAN PTY. LTD.

www.gvk.com.au

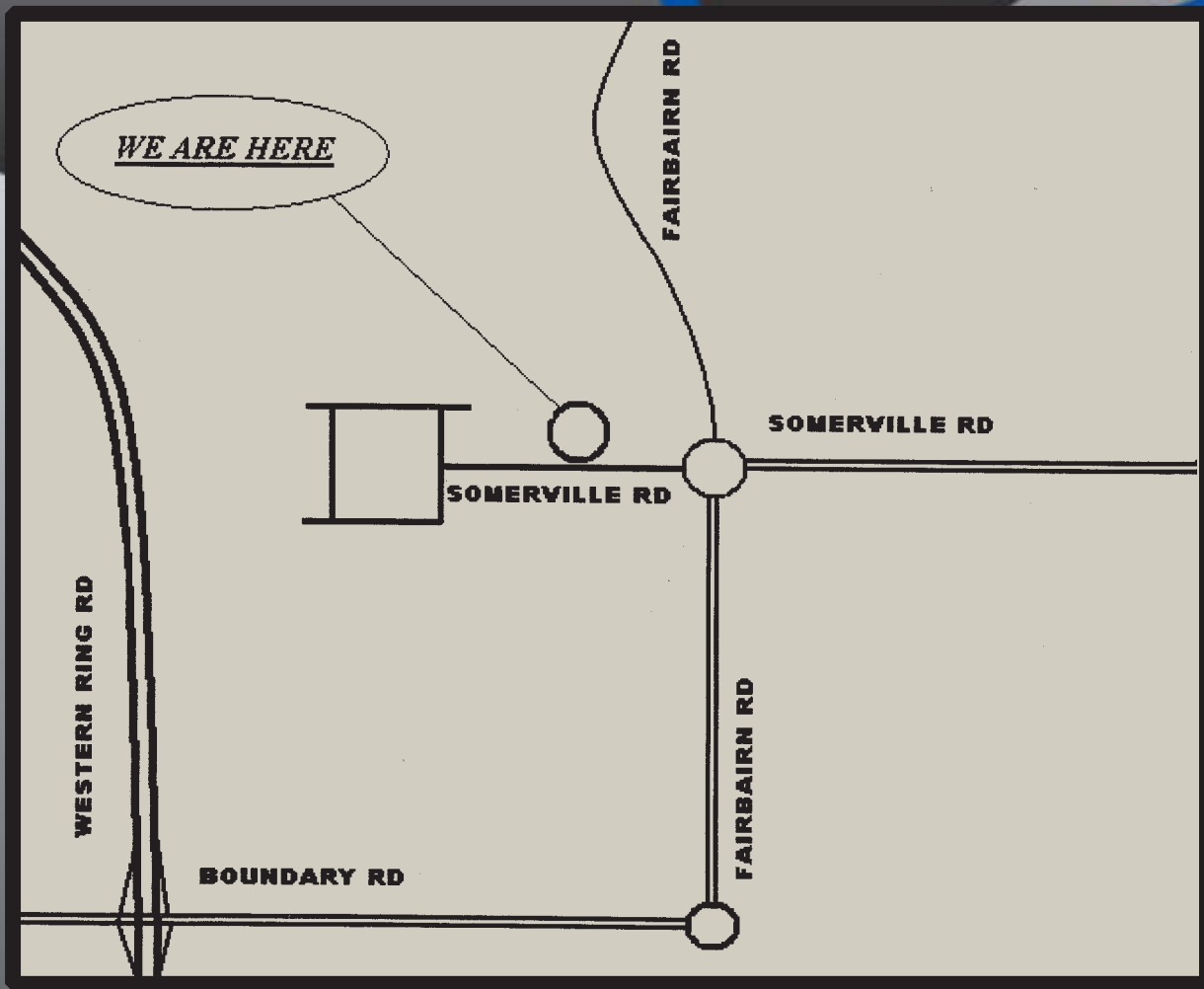

G.V. KINSMAN PTY LTD
660 SOMERVILLE ROAD
WEST SUNSHINE VIC 3020

Ph: (03) 9312 6633

Fax: (03) 9312 6433

sales@gvk.com.au

www.gvk.com.au